

PAPAGROOVE 10

D.T. :Sylvain Plante
 514-318-0946
 transylvania4@hotmail.com

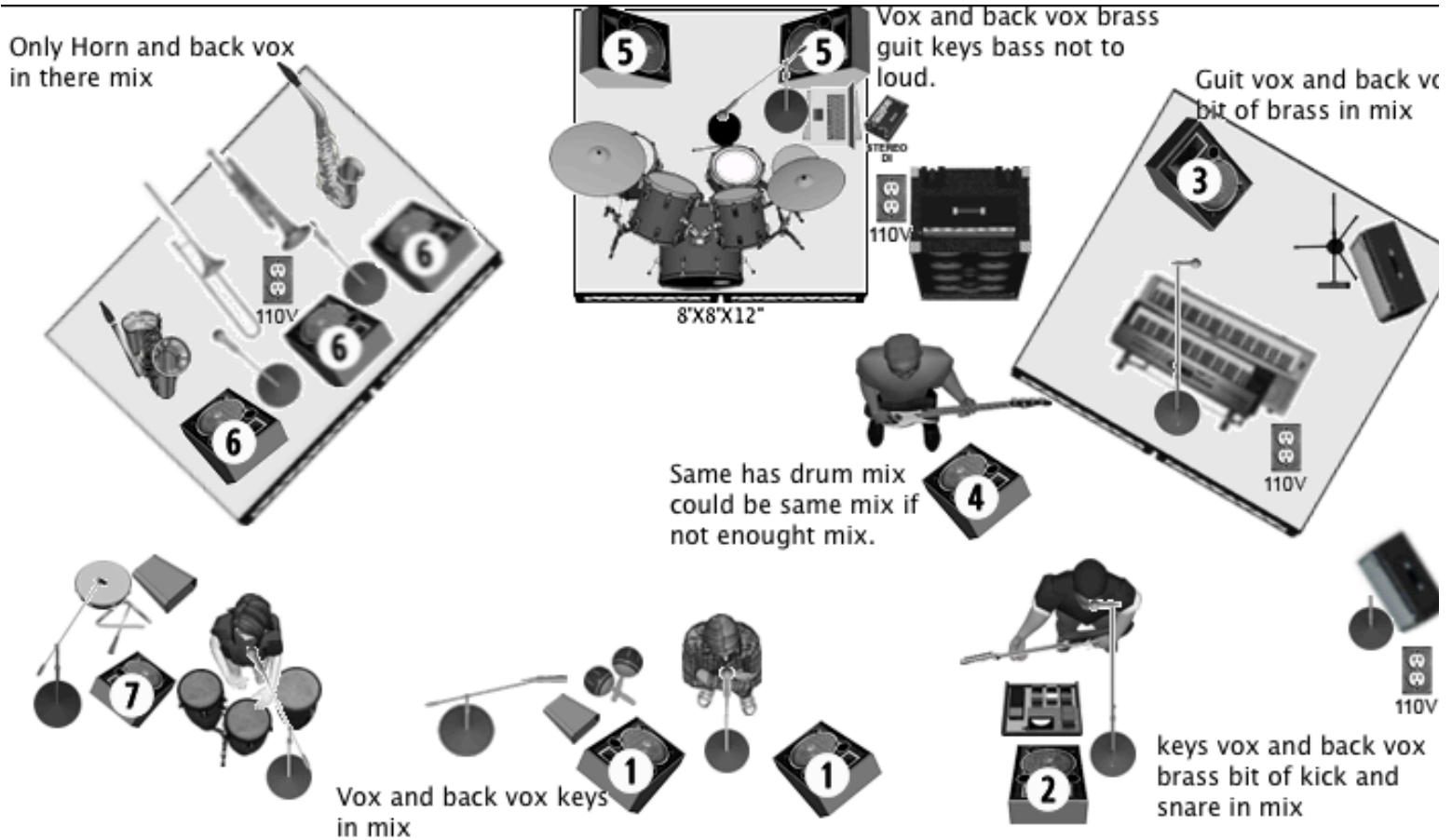

PAPAGROOVE 10 MUSICIANS

1.KICK	B-52	9.CONGA 1	SM-57	17.GUITAR	SM-57	23.BACK KEYS	sm-5
2.SNARE	SM-57	10.CONGA 2	SM-57	18.SAX ALTO	CLIP ON	24.BACK DRUM	sm-5
3.HI-HAT	COND.	11.CONGA 3	SM-57	19.T-PET	CLIP ON	25.BACK BRASS 1	sm-5
4.TOM1	E604/EQUI.	12.O.H. PERC.	COND.	20.T-BONE	CLIP ON	26.BACK BRASS 2	sm-5
5.TOM2	E604/EQUI.	13.BASS	DIRECT OUT	21.SAX BARRI	CLIP ON	27.BACK PERC.	sm-5
6.FLR TOM	E604/EQUI.	14.KEYS AMP.	SM-57	22.LEAD VOX	SM58/st.atlas	SYLVAIN PLANTE	
7.O-H 1	COND.	15.SEQUENCE	D.I. LEFT	23.PERC L.VOX	Cond./sm 57	514-318-0946	
8.O-H 2	COND.	16.SEQUENCE	D.I. RIGHT	24.BACK GUIT	SM-58	transylvania4@hotmail.com	

BACKLINE PAPAGROOVE

-Standar drum kit dw or equivalent:

- Tom 10" And 12". (remo emperor coated skin on top and remo ambassador clear on bottom)
- floor tom 14" OR 16" (remo emperor coated skin on top and remo ambassador clear on bottom)
- Bass drum 22" (remo powerstroke3 coated)
- Snare 14" (remo emperor coated on top remo snare on bottom)
- 10" splash. (Sabian HHX or equi.)
- 14" thin crash. (Sabian HHX or equi.)
- 16" thin crash. (Sabian HHX or equi.)
- 22" dry ride. (Sabian HHX or equi.)
- 14" hi hat. (Sabian HHX or equi.)
- 4 Boom cymbal stand
- Hi hat stand
- Snare stand
- Stool
- Tama Iron cobra bass drum pedal
- A carpet

Percussion :

- 3 congas l.p. ou equivalent
- 1 table a percussion
- 1 Banc de drum

Ampli de bass:

ampeg s.v.t 8x10 ou equivalent.

Ampli keys:

ampli fender devill ou equivalent.

Ampli guit:

ampli fender devill ou equivalent.

Besoin loge:

- 30 bières (3 chaques)
- 1 Vin rouge /1 Vin blanc
- Fruits et légumes
- Fromage, charcuterie et pain
- 10 Serviettes
- 1 Grand Miroir

